

Always check our website for the most updated specifications: [www.zumacollection.com](http://www.zumacollection.com)

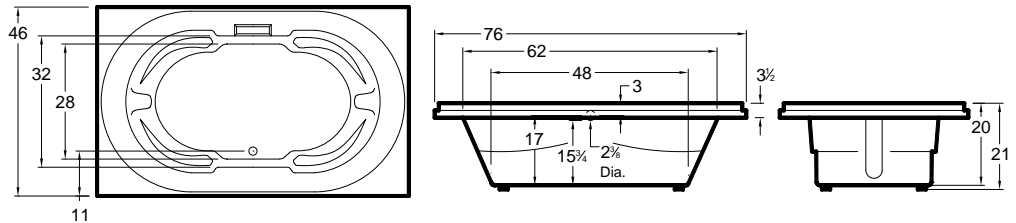

All bathtub dimensions are  $\pm 1/2"$ .

### CODES AND COMPLIANCE

Products meet or exceed the following standards:

- Underwriters Laboratories (UL)
- Underwriters Laboratories - Canada (cUL)
- ANSI Z124.1 • ANSI A112-19.7
- ANSI A112.19.8

### ELECTRICAL REQUIREMENTS

We recommend one 20 amp ground fault circuit interrupter (GFCI) for each power supply provided with the bathtub.

### DIMENSIONS

76" x 46" x 21" deep  
Whirlpool Operating Gallons = 73  
Gallon to Overflow = 95

### Whirlpool

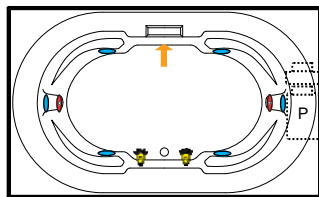

### Combination (pump and blower location only)

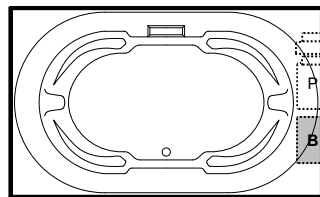

### STANDARD EQUIPMENT

- Chromotherapy
- Color Match Trim
- Grab Bar (1)
- 1 1/2 HP Pump
- Head Support
- Head & Shoulder Support
- Rotary Jets (2)
- Waste & Overflow

### OPTIONAL ACCESSORIES

- Inline Heater
- Pillow
- Tile Flange Kit

Undermount    Yes     No

### INSTALLATION TIPS

- Install product according to Owners manual and local codes.
- Any units with an Airbath III may be 1 1/2" - 2 1/2" higher than stated.
- All whirlpool or Airbath<sup>®</sup> units require an access panel.
- Hot water supply should be 65-75% of tub capacity or greater. Always consult your local plumber for recommendations as installations will vary.
- Cut-out dimension: 74" x 44"